



City of Atascadero
Community Development Department

PUBLIC INFORMATION - BUILDING SERVICES

Community Development Department 6500 Palma Avenue Atascadero, CA 93422 (805) 461-5035 fax (805) 461-7612

ELEMENTS OF A SITE PLAN

The following elements are commonly required for a typical site plan. Please check with a city planner at 461-5035 to see what is appropriate for your site plan.

1. Property address and parcel number.
2. North arrow and scale.
3. Dimensioned property lines and all building setbacks.
4. Location, name, and width (including required widening) of adjacent street.
5. Existing easements.
6. Highlight all proposed buildings and improvements, and indicate existing buildings and improvements that will be retained. Also, indicate any structures to be removed.
7. Vehicle and pedestrian access (including length, width and slope of driveway).
8. Parking spaces, traffic flow direction.
9. All on-site structures, such as walls, fences, propane tanks, etc.
10. Location of signs; existing and proposed.
11. Location and setback of septic tank and leach fields.
12. Location of utility lines (include propane tank if applicable).
13. Planted areas and outdoor use areas.
14. Location of all existing trees. List type, trunk size, canopy diameter, and status (to be removed, saved, tree protection, or other).
15. The name, location, and width of all watercourses, blue-line creeks, etc.
16. Location and use of nearest structures on adjacent properties.
17. Location to nearest fire hydrant.

Sample Commercial Business Site Plan

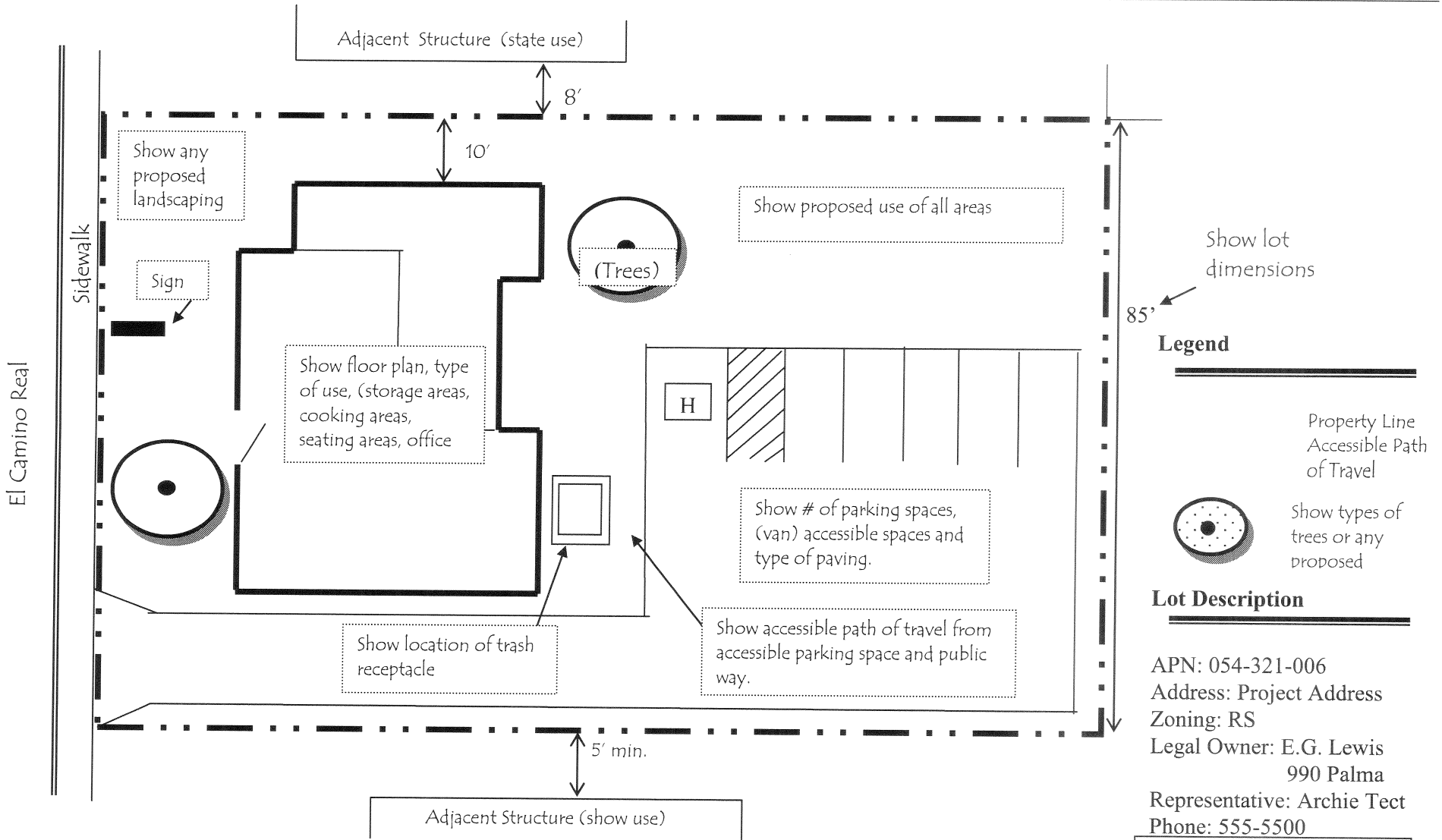

Scale: 1 inch = 20 feet

