

NOTES:

1. THE CITY OF ATASCADERO DOWNTOWN IMPROVEMENT AREA SHALL BE DESIGNATED AS THE THE HATCHED REGIONS SHOWN ABOVE.
2. THE DOWNTOWN AREA SHALL MAINTAIN STREET AND DESIGN STANDARDS PROVIDING FOR STREET LANDSCAPING AND PEDESTRIAN COMFORT.
3. REFER TO CITY OF ATASCADERO STANDARD DRAWINGS DI-2 THROUGH DI-11 FOR DOWNTOWN AREA SPECIFICATIONS.



CITY OF ATASCADERO STANDARD DRAWING

DRAWING NO.

DESCRIPTION: DOWNTOWN AREA DESIGNATION

DI-1

APPROVAL: — DATE: XX/XX/2013

REVISIONS	BY	APP	DATE
TITLE BLOCK, CURB TYPE	DMA	RST	8/20/10

RUSSELL S. THOMPSON R.C.E. C43069 EXP. 3/31/14

DRAWN BY: MRW DATE DRAWN: 8/16/06

SCALE: N.T.S.

NOTE:
 *PGE STANDARD DRAWING WILL BE USED WHEN THE ELECTRICAL LINE IS OWNED BY PGE. DEVELOPER SHALL CHECK WITH CITY ENGINEER FOR REQUIREMENTS.

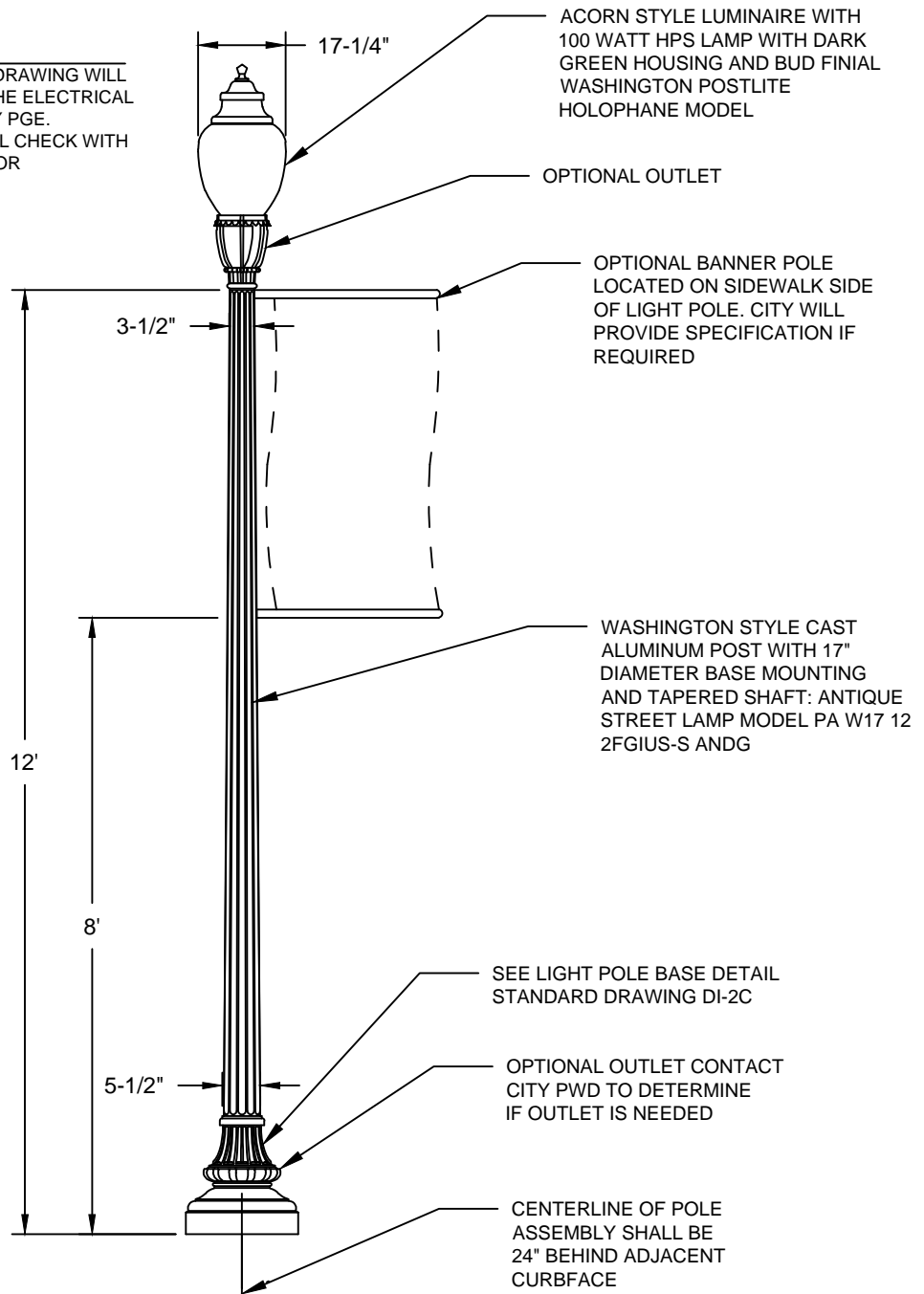

CITY OF ATASCADERO STANDARD DRAWING

DRAWING NO.

DESCRIPTION: **DOWNTOWN AREA CITY OWNED LIGHT FIXTURE**

DI-2A

APPROVAL: -- DATE: XX/XX/2013

REVISIONS BY APP DATE

RUSSELL S. THOMPSON R.C.E., C43069 EXP. 3/31/14

TITLE BLOCK, CURB TYPE DMA RST 8/20/10

DRAWN BY: MRW DATE DRAWN: 8/29/06

SCALE: N.T.S.

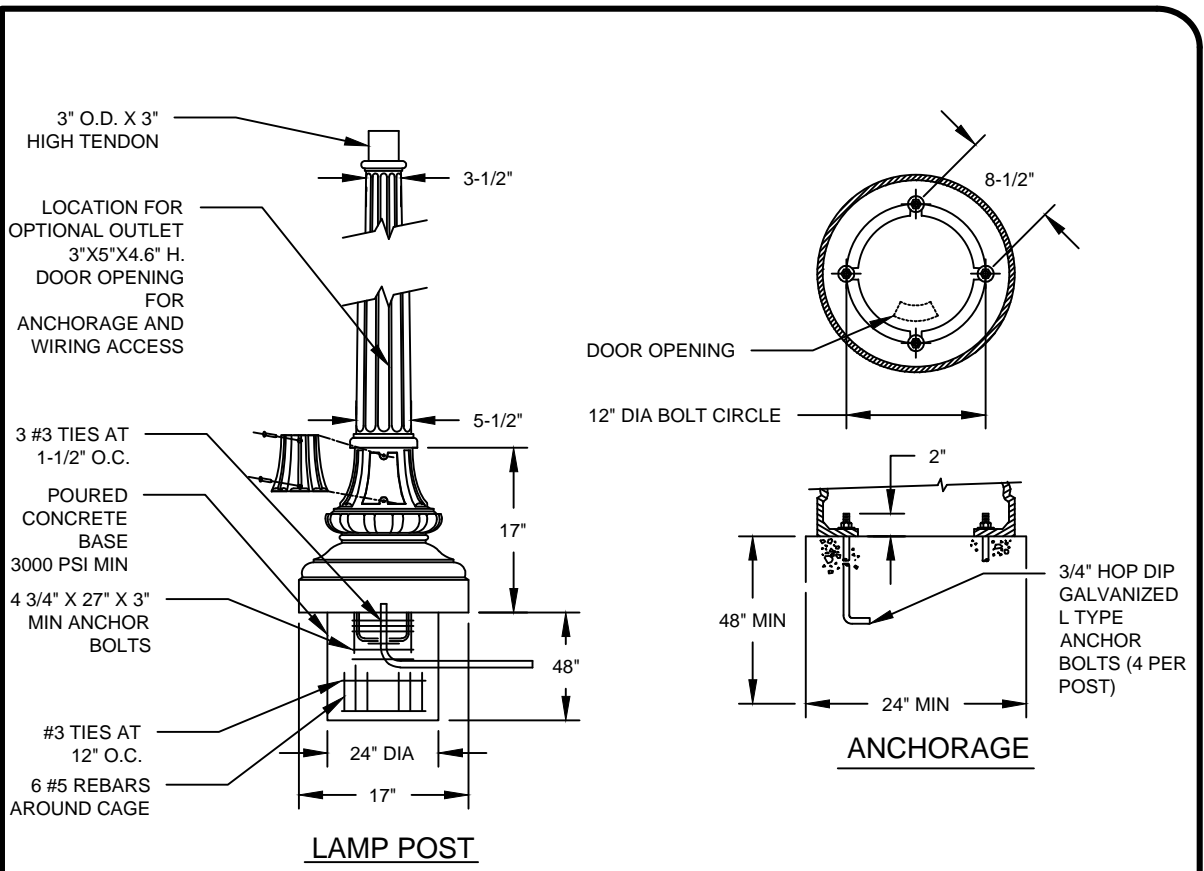

NOTE:
USE LED FIXTURE. SUBMIT
FIXTURE INFORMATION TO
ENGINEER FOR APPROVAL.
FIXTURE SHALL HAVE A 2700K
COLOR RATING.

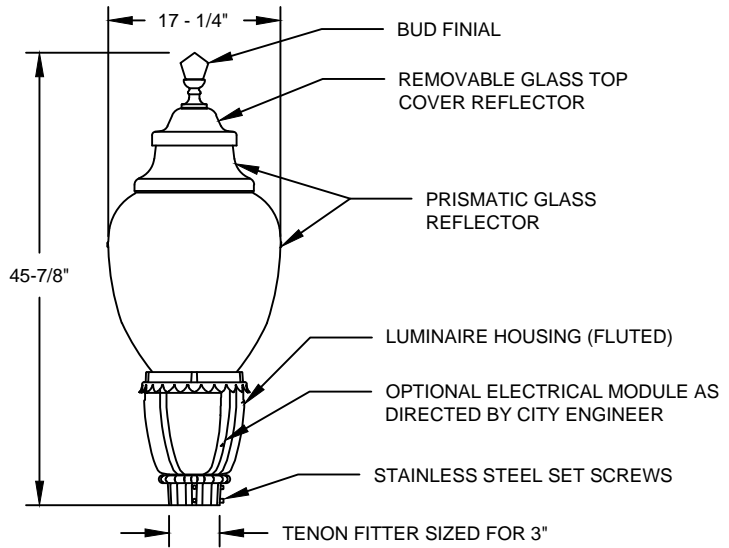

LIGHT DETAIL



CITY OF ATASCADERO STANDARD DRAWING

DRAWING NO.

DESCRIPTION: CITY OWNED FOUNDATION AND ANCHORAGE DETAIL

DI-2B

APPROVAL: -	DATE: XX/XX/2013	REVISIONS	BY	APP	DATE
RUSSELL S. THOMPSON R.C.E. C43069 EXP. 3/31/14		TITLE BLOCK, CURB TYPE	DMA	RST	8/20/10
DRAWN BY: MRW	DATE DRAWN: 8/29/06				

SCALE: N.T.S.

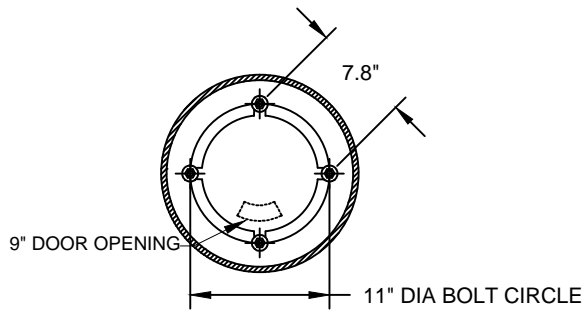

NOTE:
 1. CONTRACTOR SHALL CONFIRM SPACING AND PLACEMENT OF ANCHOR BOLTS WITH PG&E PRIOR TO INSTALLATION.
 2. FOR ANCHOR BOLT DETAILS FOR BRIDGE IMPROVEMENTS, SEE SHEET S-4.

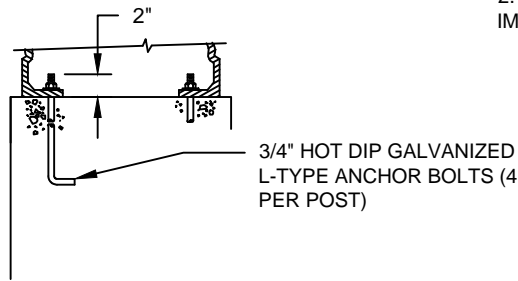

ANCHORAGE

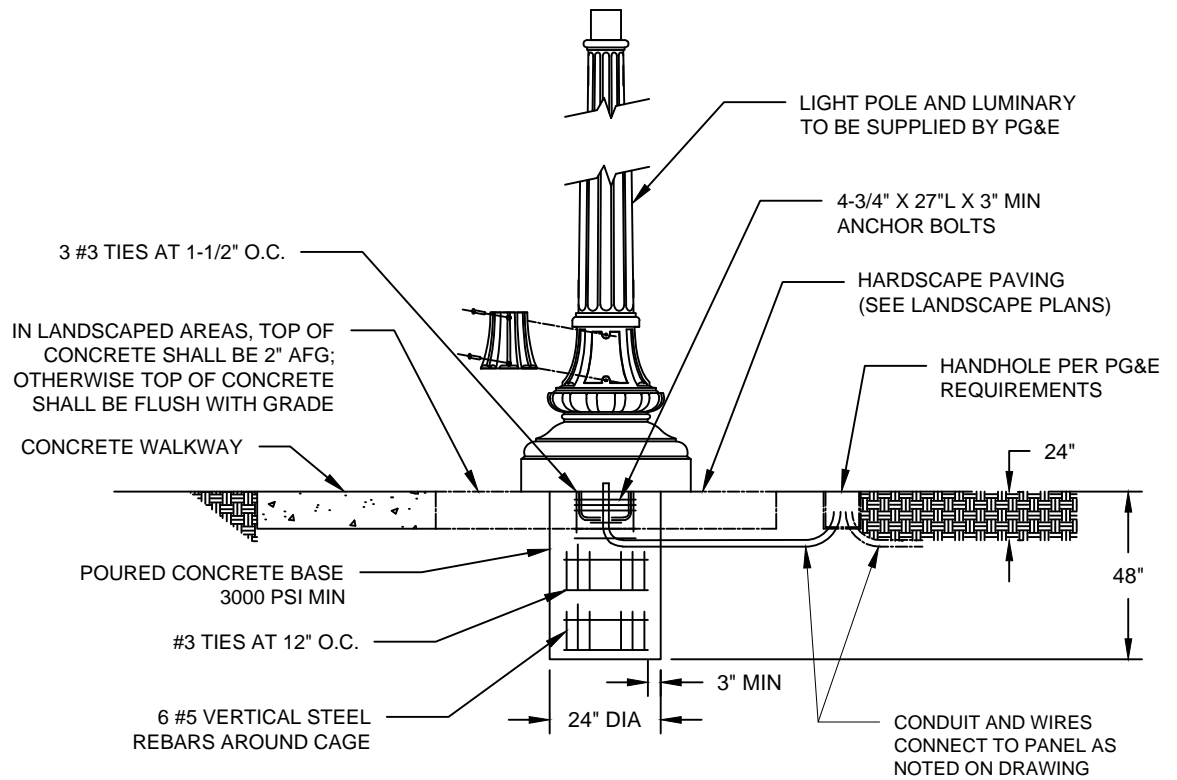

LAMP POST



CITY OF ATASCADERO STANDARD DRAWING

DRAWING NO.

DESCRIPTION: PG&E OWNED POLE: FOUNDATION & ANCHORAGE

DI-2C

APPROVAL: --	DATE: XX/XX/2013	REVISIONS	BY	APP	DATE
RUSSELL S. THOMPSON R.C.E. C43069 EXP. 3/31/14		TITLE BLOCK, CURB TYPE	DMA	RST	8/20/10
DRAWN BY: MRW	DATE DRAWN: 8/29/06				

SCALE: N.T.S.

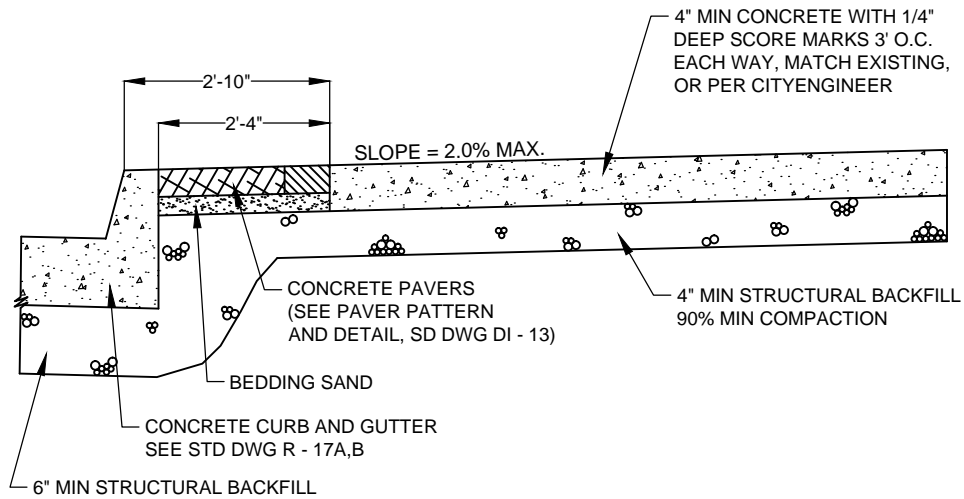

SECTION
N.T.S.

NOTES:

1. SIDEWALKS SHALL BE CLASS 2 CONCRETE; A MINIMUM OF 4" THICK. CONCRETE SHALL BE DAVIS COLOR 'PEBBLE' #614 OR APPROVED EQUAL.
2. STRUCTURE BACKFILL MATERIAL A MINIMUM OF 4" IN DEPTH AND COMPACTED TO A MINIMUM OF 90% MAXIMUM DENSITY SHALL BE PLACED UNDER THE SIDEWALK WHEN THE SUBGRADE HAS AN R-VALUE OF LESS THAN 70.
3. 1/2" EXPANSION JOINTS SHALL BE PLACED AT ALL CURB RETURNS, DRIVEWAYS AND AT VARYING INTERVALS FO 40-60' TO ALLOW MATCHING OF JOINTS ADJACENT EXISTING IMPROVEMENTS. 1/2" X 18" SMOOTH, GREASED DOWELS 24" O.C. TO BE PLACED THROUGH EXPANSION JOINTS.
4. WEAKENED PLANE JOINTS SHALL BE A MINIMUM OF 1-1/4" IN DEPTH AT INTERVALS NOT TO EXCEED 5'.
5. SIDEWALK WIDTH TO BE DETERMINED BY THE ENGINEER.
6. CURB AND GUTTER SHALL COMPLY WITH STANDARD DRAWINGS R-17A AND R-17B. CURB AND GUTTER SHALL BE DAVIS COLOR 'PEBBLE' #641 OR APPROVED EQUAL.
7. PAVER SECTION SHALL BE CONSTRUCTED TO MATCH EXISTING SECTIONS OF EL CAMINO REAL COMPLYING WITH THIS STANDARD. PAVER MODEL: TUMBLED ROMAN I, BROWN/CHARCOAL BLEND. MANUFACTURER: AIR VOL BLOCK, PHONE (805) 543-1314. OR EQUIVALENT SUBJECT TO ENGINEER'S APPROVAL.
8. POLYPROPYLENE FIBER REINFORCEMENT MAY BE SUBSTITUTED FOR REBAR. FIBER MUST HAVE THE FOLLOWING CHARACTERISTICS: 1.5 LBS/CY (0.01% BY VOLUME), 3/4" INCH MINIMUM LENGTH. FIBER-REINFORCED P.C.C. SHALL HAVE THE FOLLOWING CHARACTERISTICS: 2500 PSI @ 28 DAYS, MAX SLUMP OF 5 ".
9. PAVEMENT REMOVAL AND REPAIR: SAWCUT, REMOVE AND REPLACE A.C. PAVING, 18" MINIMUM FROM GUTTER, 8" THICK (LOCAL) AND 12" THICK (COLLECTOR, ARTERIAL). IF PAVEMENT IS P.C.C, SAWCUT EXISTING P.C.C. PAVING AT GUTTER LIP. IF EXISITING P.C.C PAVEMENT HAS AN A.C. CAP, SAWCUT AND REMOVE A.C. CAP 18" MINIMUM (EXCEPT AS REQUIRED IN THIS NOTE) FROM GUTTER LIP AND 40" UP AND DOWNSTREAM AND REPLACE A.C. TO PROVIDE A SMOOTH UNIFORM SURFACE TO MATCH EXISTING SURFACE.
10. CONCRETE FOR SIDEWALKS SHALL BE COLORED ACCORDING TO MANUFACTURER'S RECOMMENDATIONS WITH DAVIS COLORS-'PEBBLE' #641, OR APPROVED CITY EQUAL.



CITY OF ATASCADERO STANDARD DRAWING

DRAWING NO.

DESCRIPTION: **DOWNTOWN AREA SIDEWALK**

DI-3

APPROVAL: — DATE: XX/XX/2013

REVISIONS BY APP DATE

RUSSELL S. THOMPSON R.C.E. C43069 EXP. 3/31/14

TITLE BLOCK, CURB TYPE DMA RST 8/20/10

DRAWN BY: MRW DATE DRAWN: 8/29/06

SCALE: N.T.S.

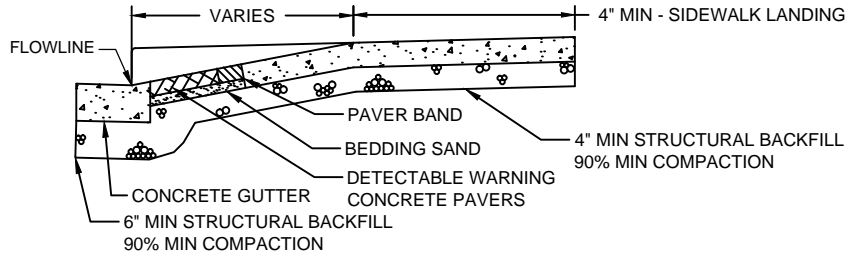

SECTION
N.T.S.

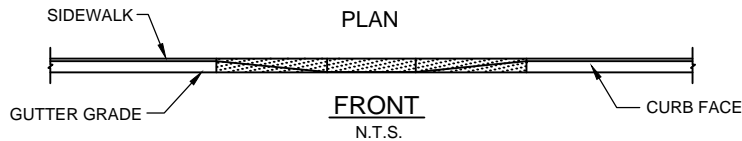
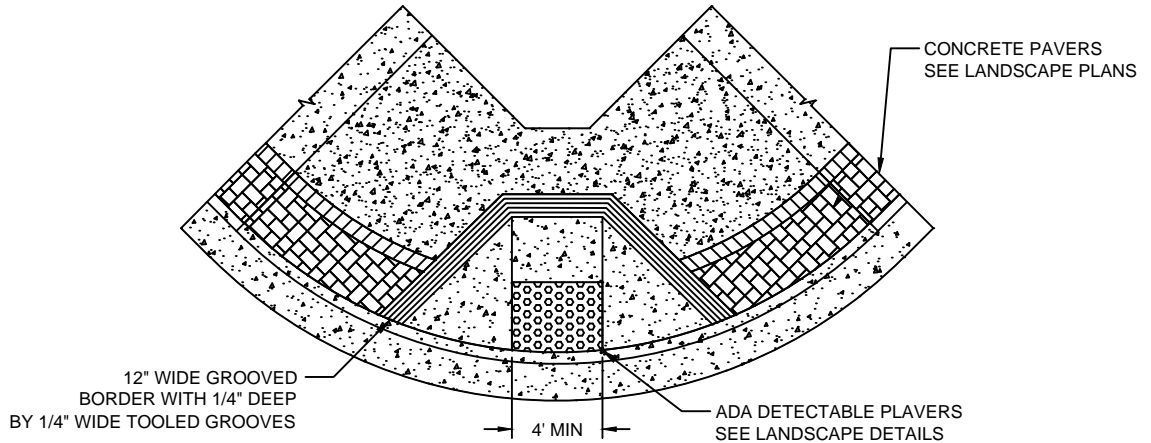

NOTES:

1. SIDEWALK RAMPS SHALL BE CLASS 2 CONCRETE AND SHALL CONFORM TO STD. DWG. R19A THROUGH R-19D.
2. STRUCTURE BACKFILL MATERIAL SHALL BE COMPACTED TO A MINIMUM OF 90% MAXIMUM DENSITY AND SHALL BE PLACED UNDER THE SIDEWALK RAMP WHEN SUBGRADE HAS AN R-VALUE LESS THAN 70.
3. PAVER SECTION SHALL BE CONSTRUCTED TO MATCH EXISTING SECTIONS OF EL CAMINO REAL COMPLYING WITH THIS STANDARD. UNIT PAVER MODEL: TUMBLED ROMAN I, BROWN/CHARCOAL BLEND. MANUFACTURER: AIR VOL BLOCK, PHONE (805) 543-1314. OR EQUIVALENT SUBJECT TO ENGINEER'S APPROVAL.
4. DETECTABLE WARNING PAVERS SHALL BE CONSTRUCTED TO MATCH EXISTING SECTIONS OF EL CAMINO REAL COMPLYING WITH THIS STANDARD. WARNING PAVER MODEL: PAVE STONES DETECTABLE WARNING PAVER, BROWN/CHARCOAL BLEND TO MATCH UNIT PAVERS. MANUFACTURER: PAVESTONE COMPANY, PHONE (916) 452-5233. OR EQUIVALENT SUBJECT TO ENGINEER'S APPROVAL.
5. CONCRETE FOR SIDEWALKS SHALL BE COLORED ACCORDING TO MANUFACTURER'S RECOMMENDATIONS WITH DAVIS COLORS-'PEBBLE' #641, OR APPROVED CITY EQUAL.
6. 1/2" EXPANSION JOINTS SHALL BE PLACED AT ALL CURB RETURNS, DRIVEWAYS, AND AT VARYING INTERVALS OF 40-60' TO ALLOW MATCHING OF JOINTS ADJACENT EXISTING IMPROVEMENTS. 1/2"X18" SMOOTH, GREASED DOWELS 24"O.C. TO BE PLACED THROUGH EXPANSION JOINTS.
7. POLYPROPYLENE FIBER REINFORCEMENT MAY BE SUBSTITUTED FOR REBAR WITH CITY ENGINEER'S APPROVAL.



CITY OF ATASCADERO STANDARD DRAWING

DRAWING NO.

DESCRIPTION: DOWNTOWN SIDEWALK RAMP

DI-4

APPROVAL: --	DATE: XX/XX/2013	REVISIONS	BY	APP	DATE
RUSSELL S. THOMPSON R.C.E. C43069 EXP. 3/31/14		TITLE BLOCK, CURB TYPE	DMA	RST	8/20/10
DRAWN BY: MRW	DATE DRAWN: 8/29/06				

SCALE: N.T.S.

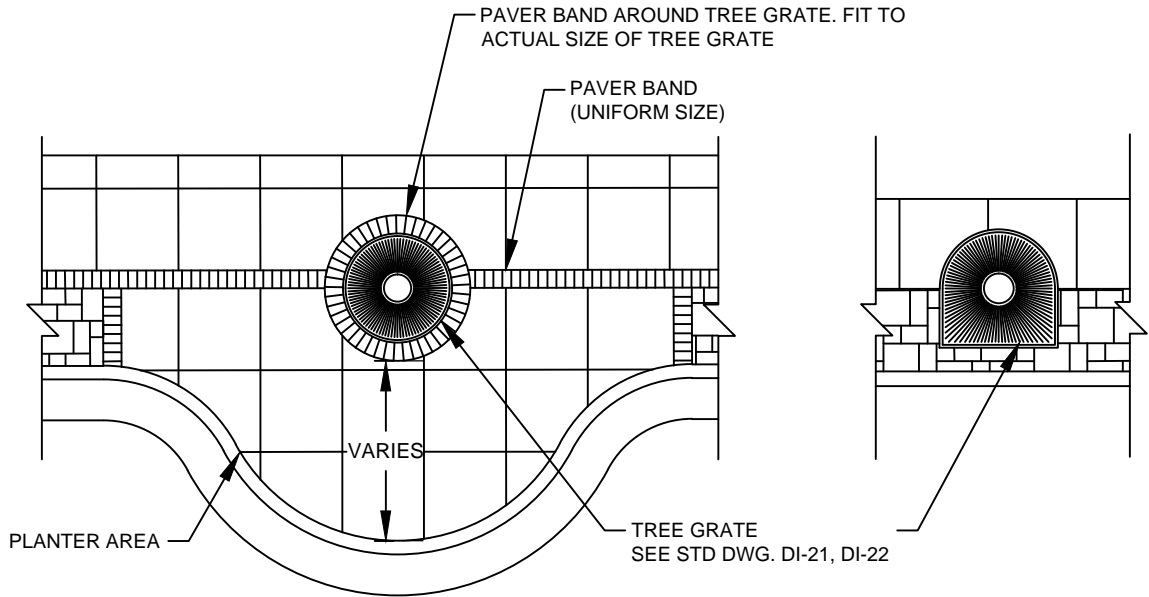

BULBOUT AND PLANTER DETAIL
N.T.S.

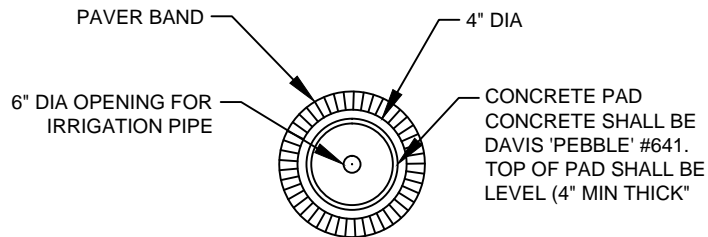

URN LAYOUT DETAIL
N.T.S.

NOTES:

1. BULBOUTS, PLANTERS, AND URNS SHALL HAVE APPROVAL OF THE ENGINEER PRIOR TO PLACEMENT OR CONSTRUCTION.
2. PAVER SECTION SHALL BE CONSTRUCTED TO MATCH EXISTING SECTIONS OF EL CAMINO REAL COMPLYING WITH THIS STANDARD. UNIT PAVER MODEL: TUMBLED ROMAN I, BROWN/CHARCOAL BLEND. MANUFACTURER: AIR VOL BLOCK, PHONE (805) 543-1314. OR EQUIVALENT SUBJECT TO ENGINEER'S APPROVAL.
3. CONCRETE FOR SIDEWALKS SHALL BE COLORED ACCORDING TO MANUFACTURER'S RECOMMENDATIONS WITH DAVIS COLORS-'PEBBLE' #641, OR APPROVED CITY EQUAL.
4. FOR TREE GRATE INSTALLATION DETAIL, PLEASE SEE STANDARD DRAWING DI-20.



CITY OF ATASCADERO STANDARD DRAWING

DRAWING NO.

DESCRIPTION: DOWNTOWN AREA BULBOUT, URN AND PLANTER DETAILS

DI-5

APPROVAL: --	DATE: XX/XX/2013	REVISIONS	BY	APP	DATE
RUSSELL S. THOMPSON R.C.E. C43069 EXP. 3/31/14		TITLE BLOCK, CURB TYPE	DMA	RST	8/20/10
DRAWN BY: MRW	DATE DRAWN: 8/29/06				

SCALE: N.T.S.

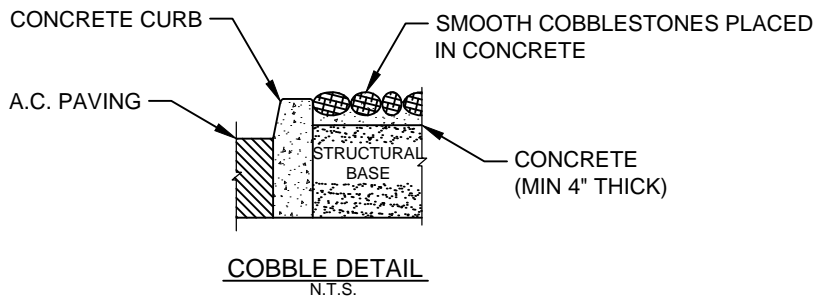
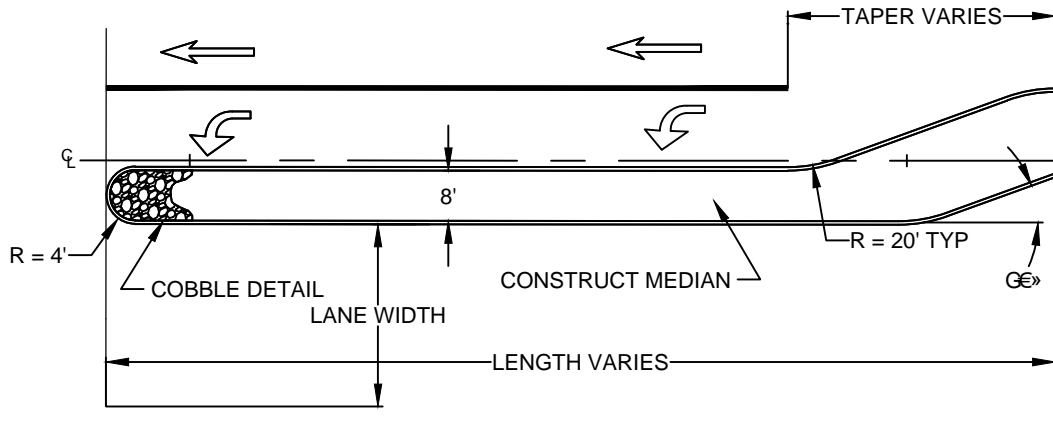

NOTES:

1. ROADWAY MEDIANS SHALL BE CONSTRUCTED WITH APPROVAL OF THE CITY ENGINEER.
2. MEDIANS SHALL BE INSTALLED WITH COBBLESTONES AS APPROVED BY THE CITY ENGINEER.
3. DEVIATIONS FROM TO MEDIANS SHALL BE APPROVED BY THE CITY ENGINEER.

	CITY OF ATASCADERO STANDARD DRAWING						DRAWING NO.
	DESCRIPTION: DOWNTOWN AREA MEDIANS						DI-6
	APPROVAL: —	DATE: XX/XX/2013	REVISIONS	BY	APP	DATE	SCALE: N.T.S.
RUSSELL S. THOMPSON R.C.E. C43069 EXP. 3/31/14		TITLE BLOCK, CURB TYPE	DMA	RST	8/20/10		
DRAWN BY: MRW		DATE DRAWN: 8/29/06					

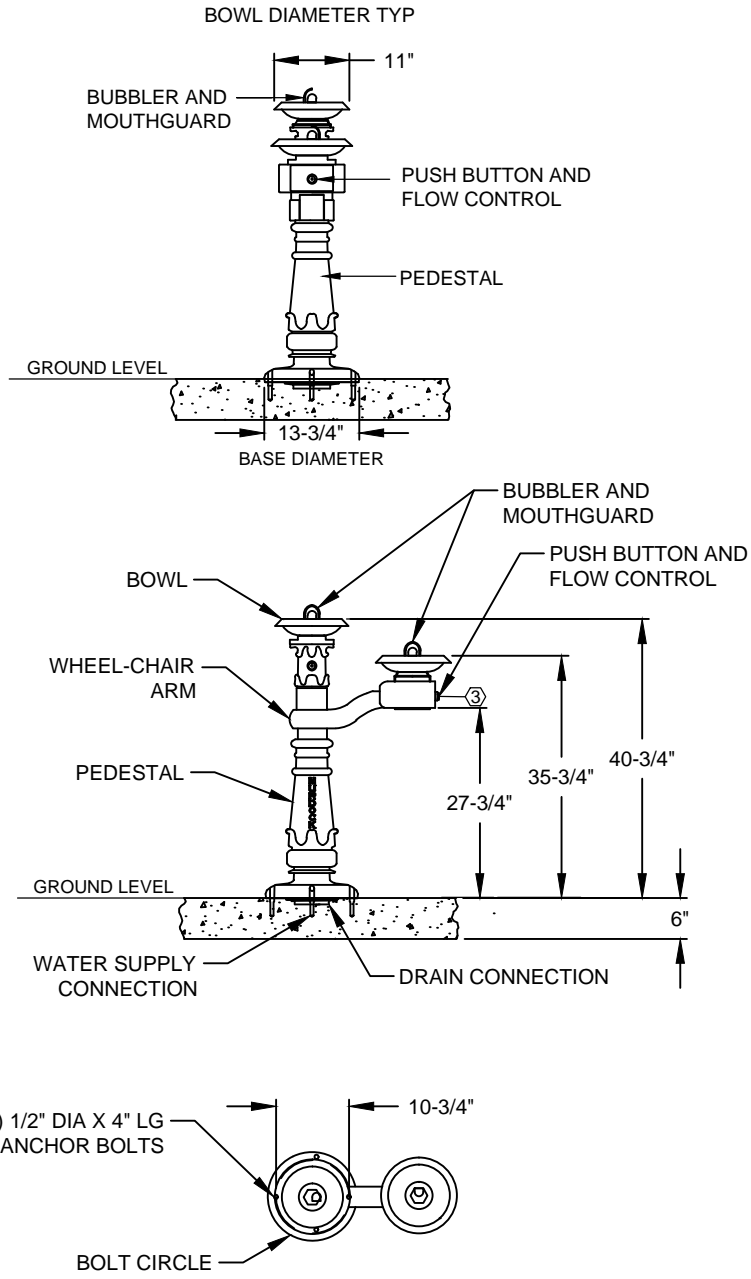

NOTES:

1. ALL PROPOSED DRINKING FOUNTAINS SHALL MATCH EXISTING FOUNTAINS IN DOWNTOWN AREA.
2. PRODUCT DETAILS: MODEL MC76-2, BLACK. MANUFACTURER: MURDOCK, INC. WWW.MURDOCKFOUNTAINS.COM. OR CITY ENGINEER APPROVED EQUIVALENT.
3. SINGLE OR DOUBLE BOWL APPLICATIONS ARE ACCEPTED UPON THE CITY ENGINEER'S APPROVAL.



CITY OF ATASCADERO STANDARD DRAWING

DRAWING NO.

DESCRIPTION: DOWNTOWN AREA DRINKING FOUNTAINS

DI-7

APPROVAL: —	DATE: XX/XX/2013	REVISIONS	BY	APP	DATE
RUSSELL S. THOMPSON R.C.E. C43069 EXP. 3/31/14		TITLE BLOCK, CURB TYPE	DMA	RST	8/20/10
DRAWN BY: MRW		DATE DRAWN: 8/29/06			

SCALE: N.T.S.

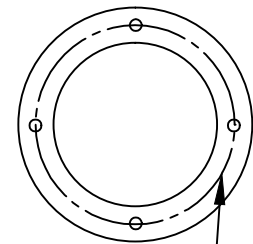
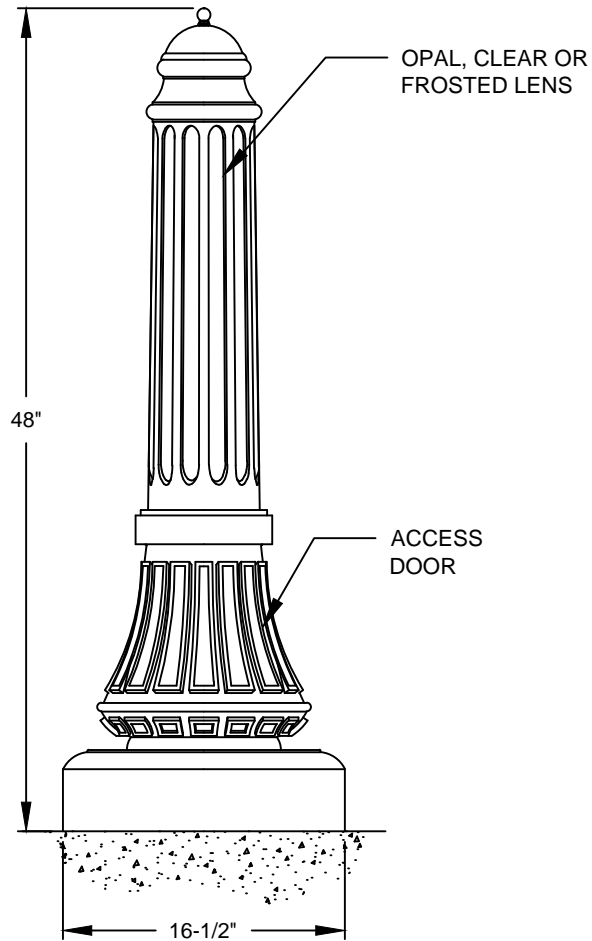

13" DIA BOLT CIRCLE
4 HOLES SPACED
EQUALLY. VERIFY WITH
MANUFACTURER PRIOR
TO INSTALLATION.

BOLT PATTERN
N.T.S.

NOTES:

1. THE DOWNTOWN AREA BOLLARDS SHALL CONFORM TO THIS STANDARD. PRODUCT NUMBER: BOL-3024L. MANUFACTURER: ELA LIGHTING, (626) 965-0821. DISTRIBUTED BY PACIFIC LIGHTING INC, (949) 597-1633, WWW.PLS-INC.COM.
2. BOLLARD SHALL HAVE A GREEN (VERDE) FINISH, METAL HALIDE LAMP WITH A BALLAST WATTAGE OF 70 W AND VOLTAGE OF 120 V.
3. CITY ENGINEER APPROVED EQUIVALENT MAY BE USED.
4. INSTALLATION PER MANUFACTURERS RECOMMENDATIONS.



CITY OF ATASCADERO STANDARD DRAWING

DRAWING NO.

DESCRIPTION: DOWNTOWN AREA BOLLARD

DI-8

APPROVAL: —	DATE: XX/XX/2013	REVISIONS	BY	APP	DATE
RUSSELL S. THOMPSON R.C.E. C43069 EXP. 3/31/14		TITLE BLOCK, CURB TYPE	DMA	RST	8/20/10
DRAWN BY: MRW	DATE DRAWN: 8/29/06				

SCALE: N.T.S.

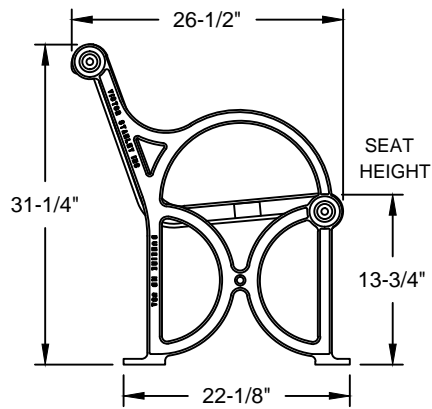

PROFILE
N.T.S.

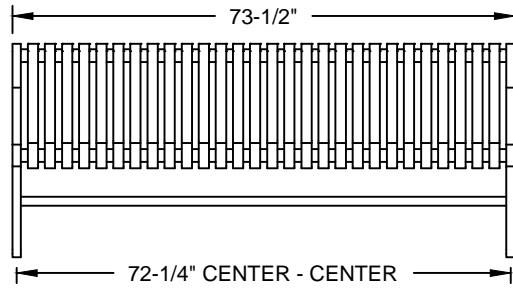

CENTER-TO-CENTER DISTANCES ARE APPROXIMATE

FRONT
N.T.S.

28 SCROLLED VERTICAL
STEEL SLATS ARE FORMED
FROM SECTIONS OF
1/4" X 1-1/2"
SOLID STEEL BARS

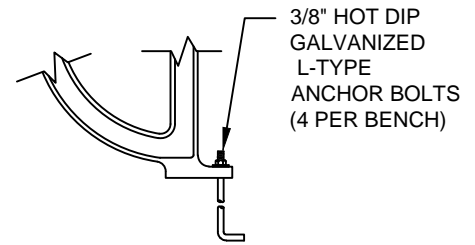
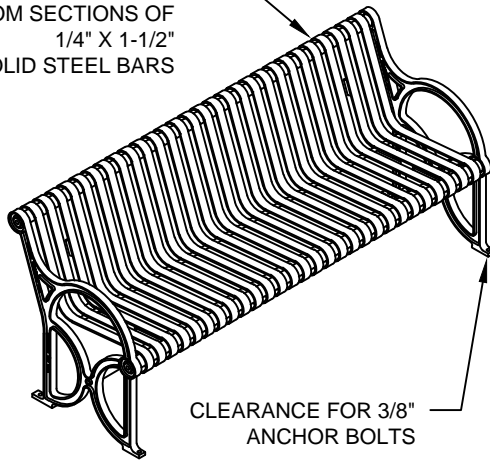

ANCHORAGE A
NEW SLAB

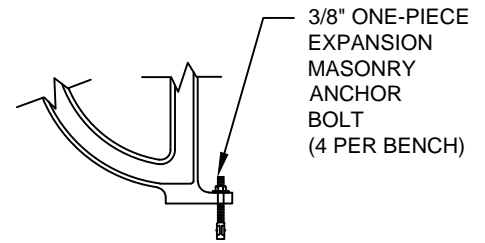

ANCHORAGE B
EXISTING SLAB

NOTES:

1. ALL BENCHES LOCATED IN THE DOWNTOWN AREA SHALL MATCH THIS STANDARD. MODEL NUMBER: C-18, CITY SERIES 6' CONTOURED BENCH WITH VERTICAL STEEL SCROLLS. COLOR: BLACK. MANUFACTURER: VICTOR STANLEY, WWW.VICTORSTANLEY.COM.
2. BENCH FOOTINGS ARE MANUFACTURED FOR INTALLATION MOUNTING WITH (4) 3/8" ANCHOR BOLTS.
3. DRAWING NOT TO SCALE.
4. BENCHES PLACED IN BUS SHELTERS SHALL BE INSTALLED SO THAT A 4' MIN. CLEARANCE REMAINS BETWEEN ONE SHELTER SIDE AND THE BENCH, TO ACCOMMODATE WHEELCHAIRS.



CITY OF ATASCADERO STANDARD DRAWING

DESCRIPTION: **DOWNTOWN AREA BENCHES**

APPROVAL: — DATE: XX/XX/2013
 RUSSELL S. THOMPSON R.C.E. C43069 EXP. 3/31/14
 DRAWN BY: MRW DATE DRAWN: 8/29/06

REVISIONS	BY	APP	DATE
TITLE BLOCK, CURB TYPE	DMA	RST	8/20/10

DRAWING NO.

DI-9

SCALE: N.T.S.

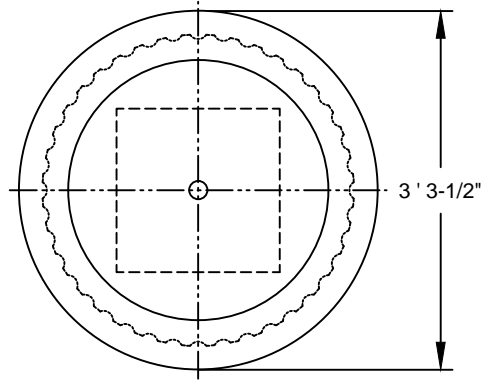

PLAN VIEW

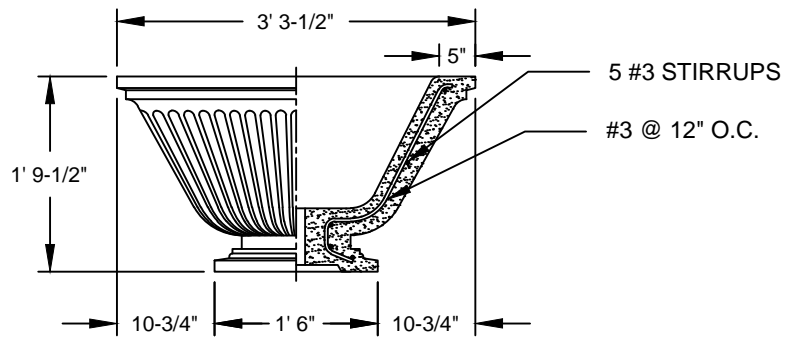

SECTION

NOTES:

1. URNS LOCATED WITHIN THE DOWNTOWN AREA SHALL CONFORM TO THIS STANDARD AND ARE SUBJECT TO THE CITY ENGINEER'S APPROVAL.
2. URN PLANTING SHALL CONFORM TO THE APPROVED PLANT SPECIFICATIONS SUBJECT TO APPROVAL BY THE CITY.
3. URNS SHALL BE DURA ART STONE MODEL: CAST STONE JUDICIAL URN. MODEL #S-203, (650)965-7100. OR APPROVED EQUIVALENT.



CITY OF ATASCADERO STANDARD DRAWING

DRAWING NO.

DESCRIPTION: DOWNTOWN AREA URNS

DI-10

APPROVAL: —	DATE: XX/XX/2013	REVISIONS	BY	APP	DATE
RUSSELL S. THOMPSON R.C.E. C43069 EXP. 3/31/14		TITLE BLOCK, CURB TYPE	DMA	RST	8/20/10
DRAWN BY: MRW	DATE DRAWN: 8/29/06				

SCALE: N.T.S.

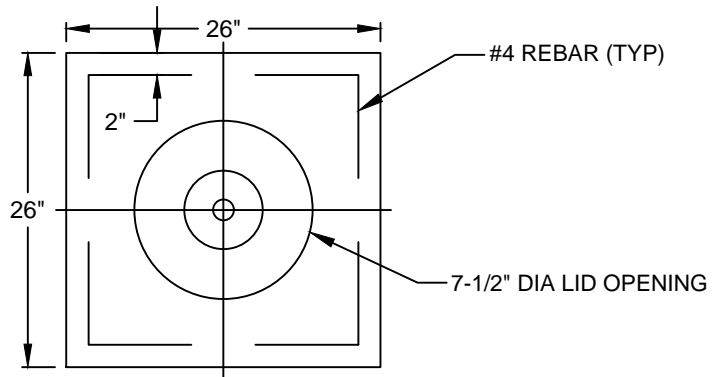

PLAN VIEW OF 4" PCC PAD

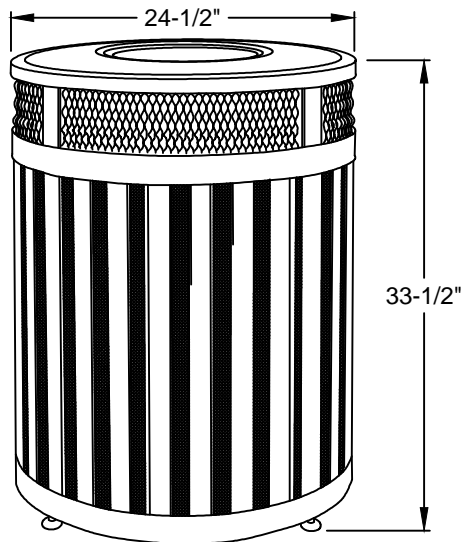

SECTION

NOTES:

1. TRASH RECEPTACLES LOCATED WITHIN THE DOWNTOWN AREA SHALL CONFORM TO THIS STANDARD AND ARE SUBJECT TO THE CITY ENGINEER'S APPROVAL.
2. TRASH RECEPTACLES SHALL BE UNITED RECEPTACLE MODEL: MH-46.
 COLOR/FINSISH: BLACK, 37 GALLONS, LARGE ROUND OPEN TOP, SURFACE MOUNT FINISH, USE LEG LEVELERS AS APPROPRIATE, INSTALL PER MANUFACTURERS REC. AND PER PLANS. (800)233-0314. OR APPROVED EQUIVALENT.



CITY OF ATASCADERO STANDARD DRAWING

DRAWING NO.

DESCRIPTION: DOWNTOWN AREA TRASH RECEPTACLES					
APPROVAL: —	DATE: XX/XX/2013	REVISIONS	BY	APP	DATE
RUSSELL S. THOMPSON R.C.E. C43069 EXP. 3/31/14		TITLE BLOCK, CURB TYPE	DMA	RST	8/20/10
DRAWN BY: MRW	DATE DRAWN: 8/29/06				

DI-11

SCALE: N.T.S.

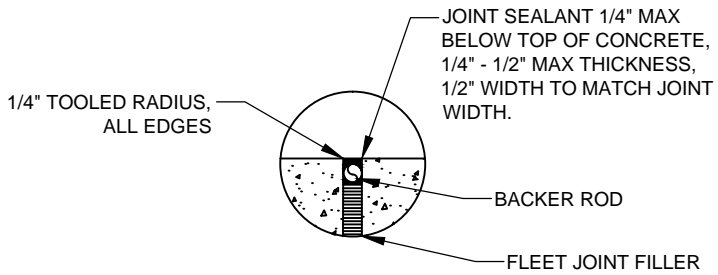

ENLARGEMENT

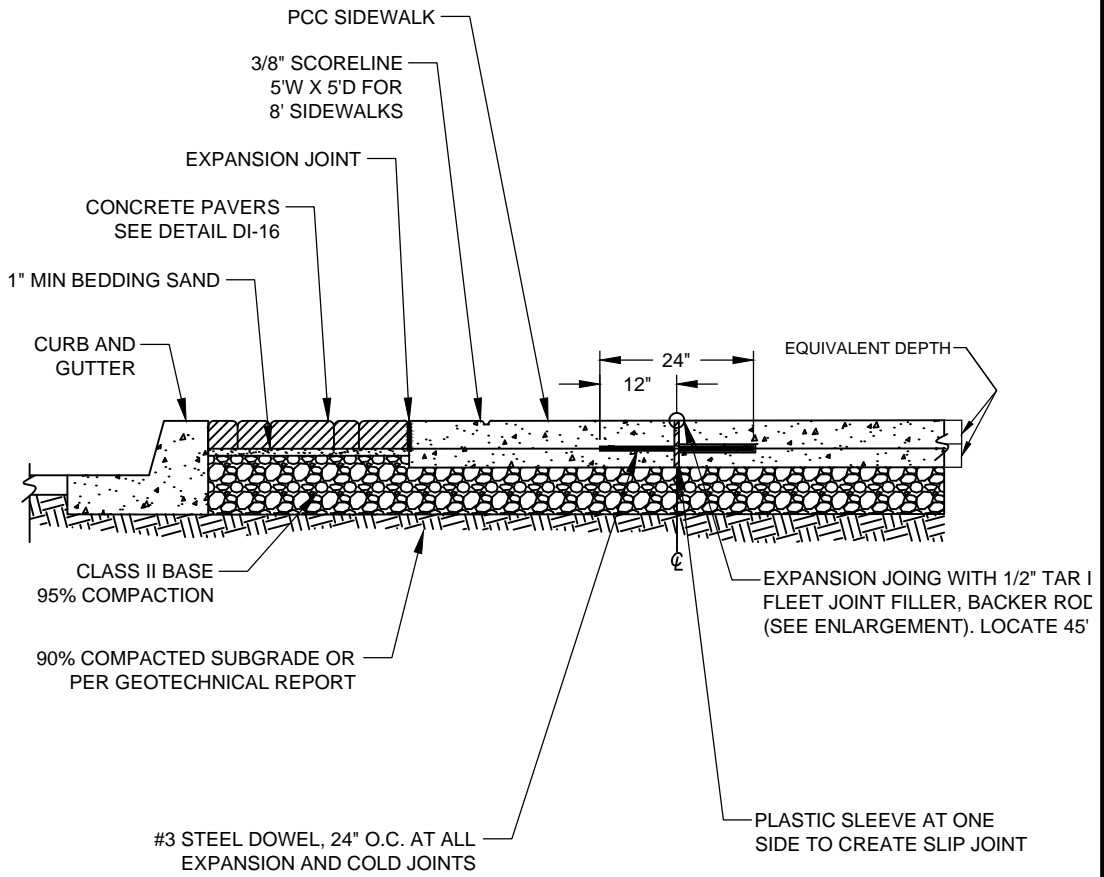

NOTES: SIDEWALKS SHALL BE CLASS 2 CONCRETE; 4" THICK MIN



CITY OF ATASCADERO STANDARD DRAWING

DRAWING NO.

DESCRIPTION: **DOWNTOWN 8' SIDEWALK**

DI-12

APPROVAL: —	DATE: XX/XX/2013	REVISIONS	BY	APP	DATE
RUSSELL S. THOMPSON R.C.E. C43069 EXP. 3/31/14		TITLE BLOCK, CURB TYPE	DMA	RST	8/20/10
DRAWN BY: MRW	DATE DRAWN: 8/29/06				

SCALE: N.T.S.

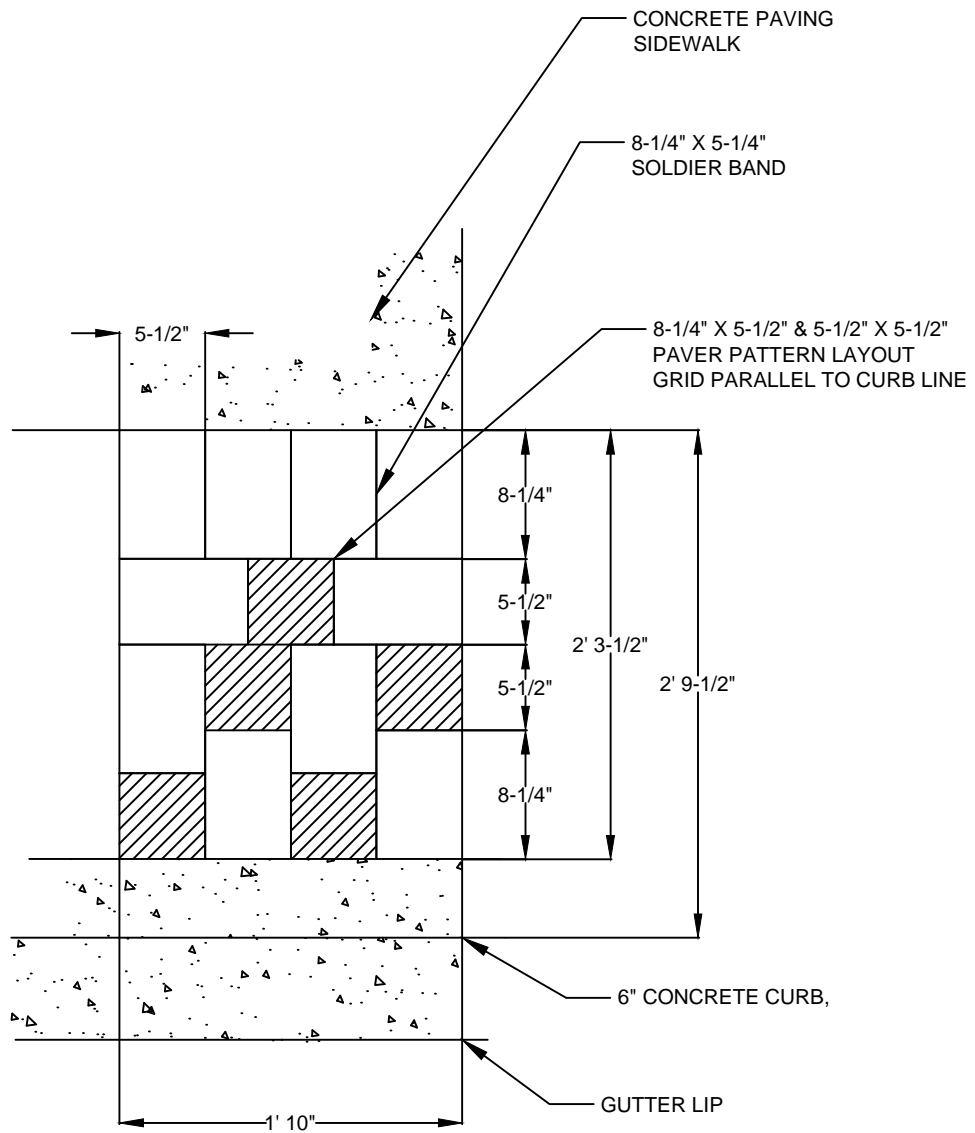

NOTES:

1. PAVER TYPE: SHALL BE AIRVOL BLOCK INC., TUMBLED TOMAN 1, COLOR BROWN CHARCOAL BLEND, 60 MIL THICK.
2. PAVER PATTERN: SHALL BE 8¹/₄" X 5¹/₂" PAVER & 5¹/₂" X 5¹/₂" PAVER MIX. LAYOUT GRID PATTERN AS DETAILED.
3. INSTALL PER MANUFACTURER'S SPECIFICATIONS.



CITY OF ATASCADERO STANDARD DRAWING

DRAWING NO.

DESCRIPTION: CONCRETE PAVER BAND PATTERN DOWNTOWN SIDEWALK

DI-13

APPROVAL: —	DATE: XX/XX/2013	REVISIONS	BY	APP	DATE
RUSSELL S. THOMPSON R.C.E. C43069 EXP. 3/31/14		TITLE BLOCK, CURB TYPE	DMA	RST	8/20/10
DRAWN BY: MRW	DATE DRAWN: 8/29/06				

SCALE: N.T.S.

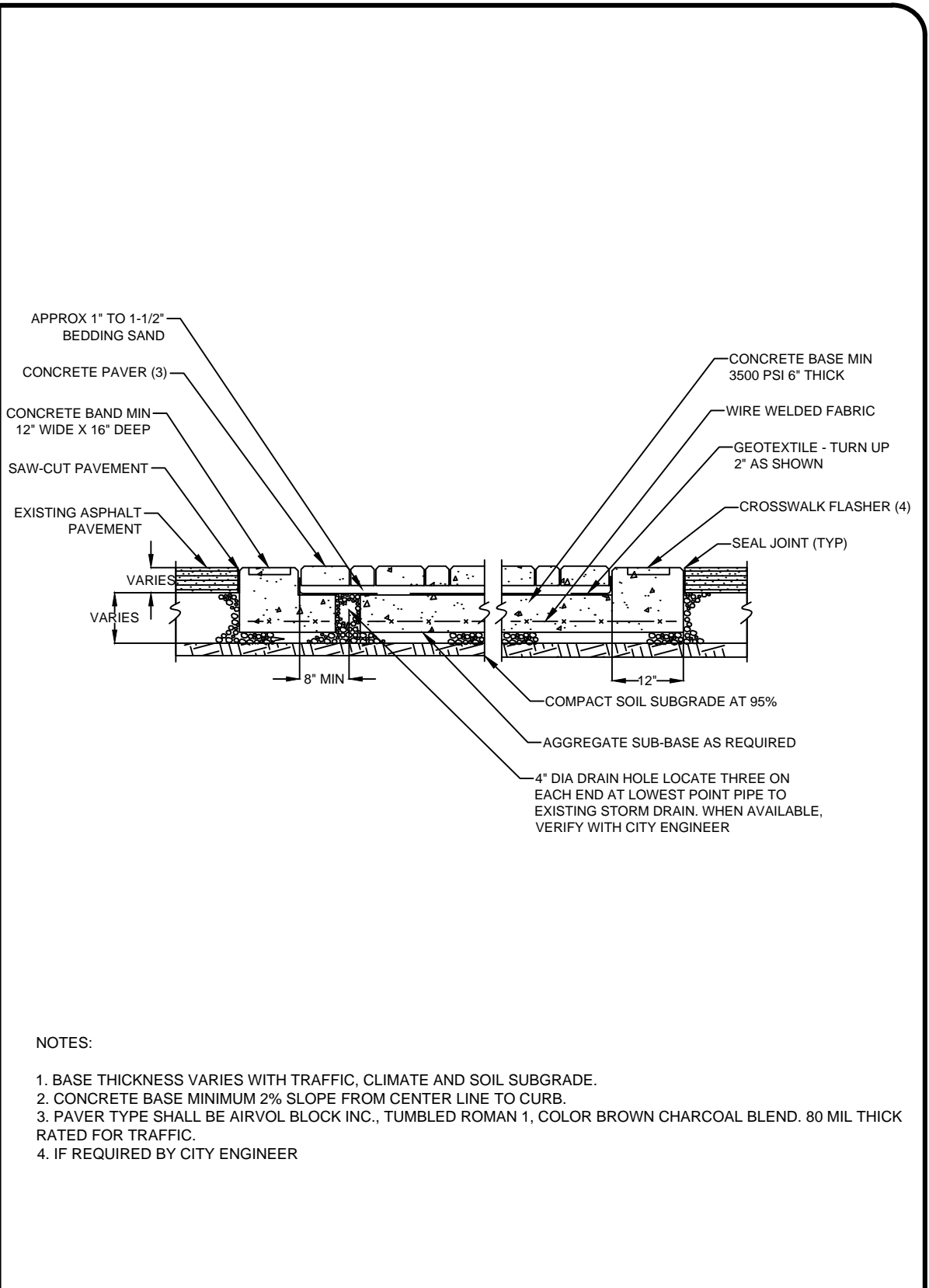

NOTES:

1. BASE THICKNESS VARIES WITH TRAFFIC, CLIMATE AND SOIL SUBGRADE.
2. CONCRETE BASE MINIMUM 2% SLOPE FROM CENTER LINE TO CURB.
3. PAVER TYPE SHALL BE AIRVOL BLOCK INC., TUMBLED ROMAN 1, COLOR BROWN CHARCOAL BLEND. 80 MIL THICK RATED FOR TRAFFIC.
4. IF REQUIRED BY CITY ENGINEER

	CITY OF ATASCADERO STANDARD DRAWING						DRAWING NO.
	DESCRIPTION: CONCRETE BAND FOR CROSSWALK						DI-14
	APPROVAL: —	DATE: XX/XX/2013	REVISIONS	BY	APP	DATE	SCALE: N.T.S.
RUSSELL S. THOMPSON R.C.E. C43069 EXP. 3/31/14	DRAWN BY: MRW	TITLE BLOCK, CURB TYPE	DMA	RST	8/20/10		

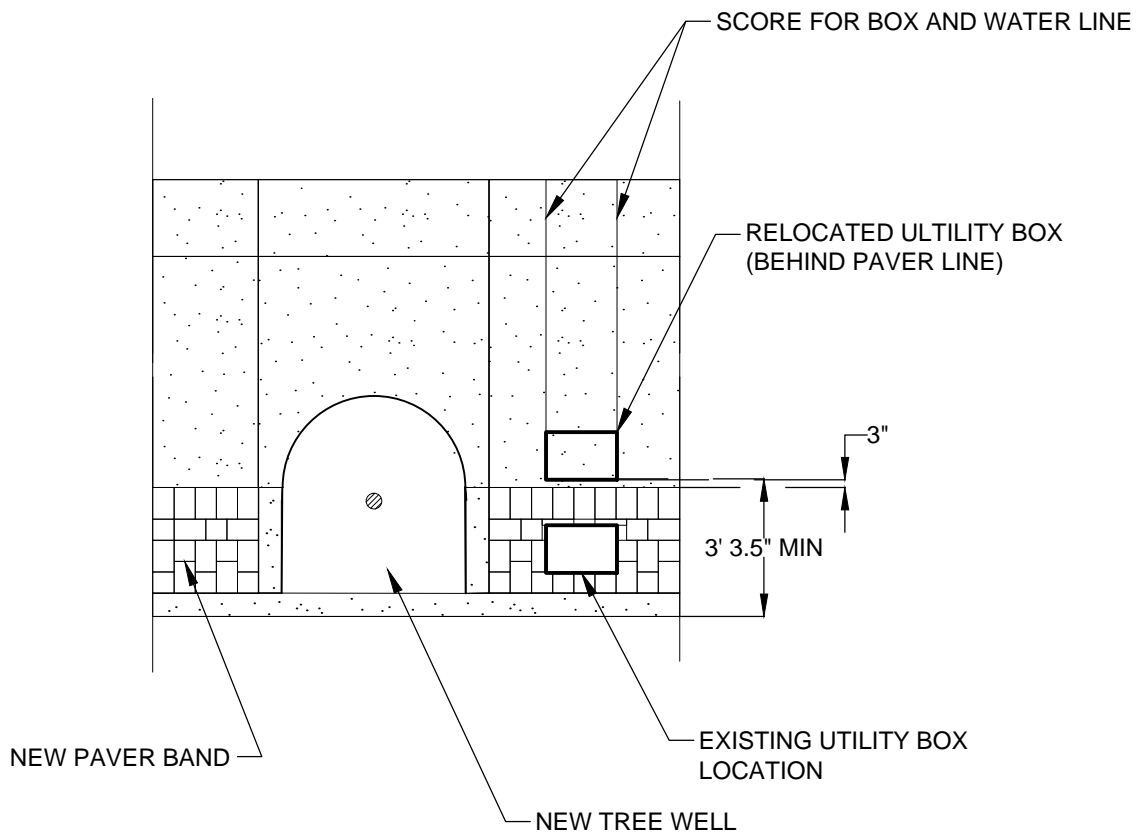

CITY OF ATASCADERO STANDARD DRAWING

DRAWING NO.

DESCRIPTION: **TYPICAL UTILITY BOX RELOCATION LOCATION**

DI-15

APPROVAL: -	DATE: XX/XX/2013	REVISIONS	BY	APP	DATE
RUSSELL S. THOMPSON R.C.E. C43069 EXP. 3/31/14		TITLE BLOCK, CURB TYPE	DMA	RST	8/20/10
DRAWN BY: MRW	DATE DRAWN: 8/29/06				

SCALE: N.T.S.

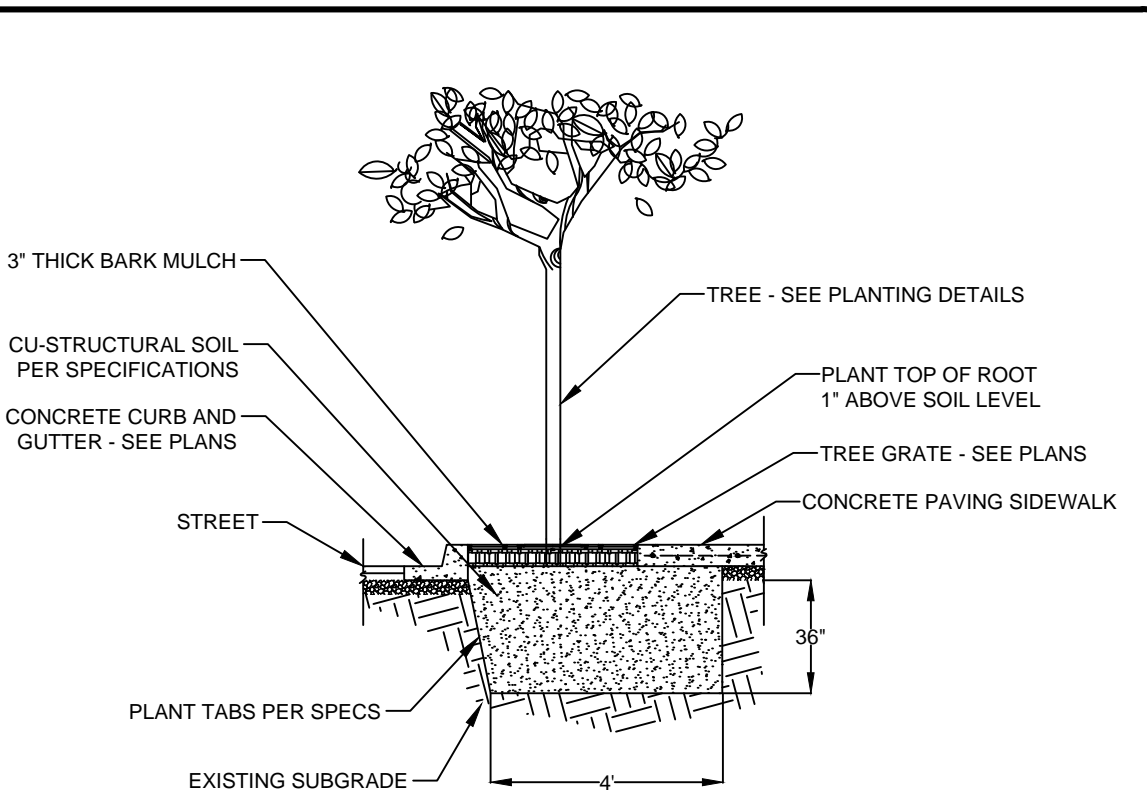

SECTION

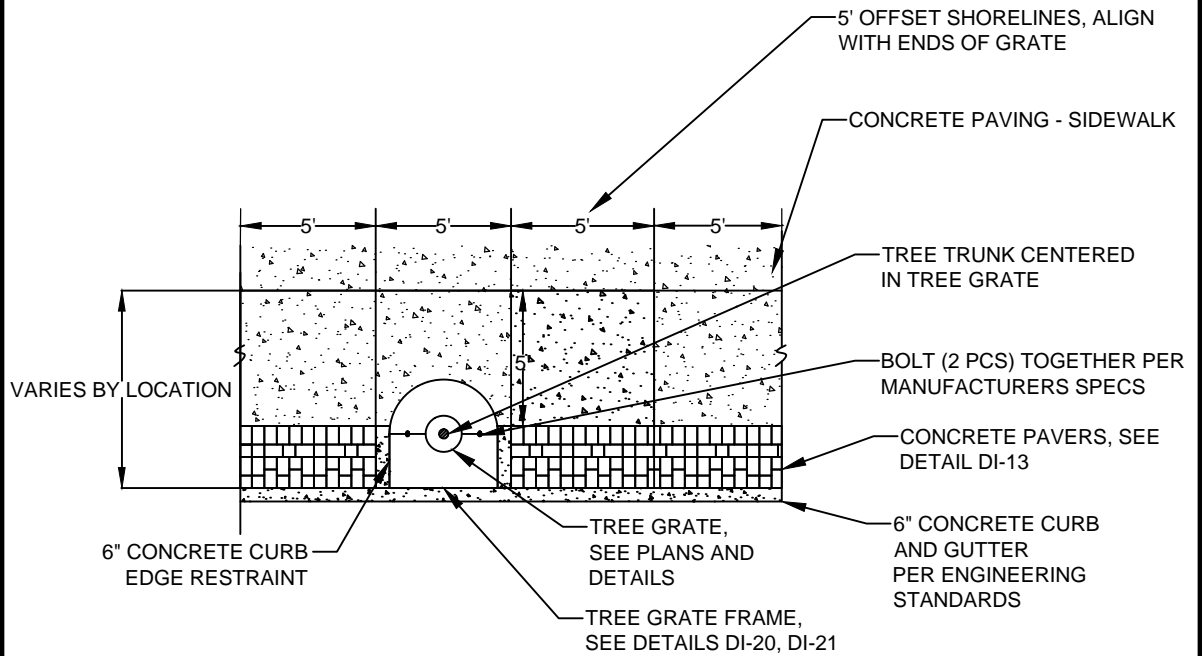

PLAN



CITY OF ATASCADERO STANDARD DRAWING

DRAWING NO.

DESCRIPTION: **DOWNTOWN TREE PLANTING DETAIL**

DI-16

APPROVAL: —	DATE: XX/XX/2013	REVISIONS	BY	APP	DATE
RUSSELL S. THOMPSON R.C.E. C43069 EXP. 3/31/14		TITLE BLOCK, CURB TYPE	DMA	RST	8/20/10
DRAWN BY: MRW	DATE DRAWN: 8/29/06				

SCALE: N.T.S.

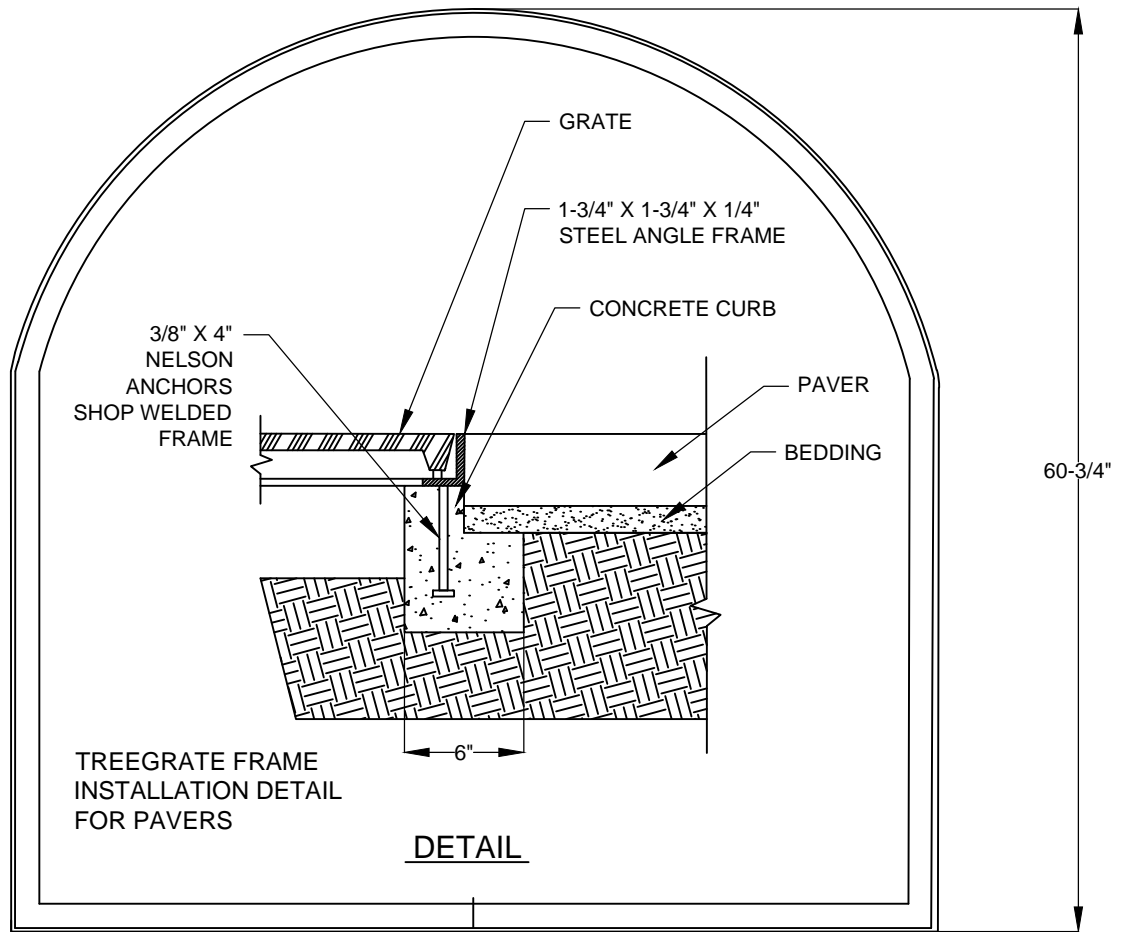

PLAN

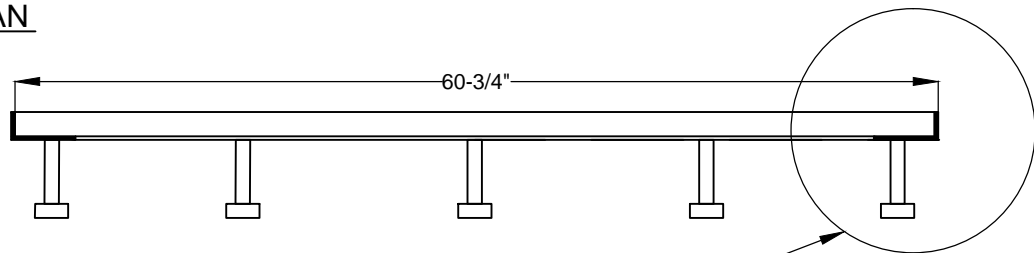

SECTION

SEE DETAIL

NOTES:

1. FRAME JIG WELDED FROM 1-3/4" X 1-3/4" X 1/4" STEEL ANGLE PER ASTM A36
2. ANCHORS 1/2" NELSON ANCHORS MACHINE WELDED TO FRAME
3. FRAMES CN BE HOT DIPPED GALVANIZED AND/OR PAINTED TO MATCH GRATES
4. GRATE FRAME TOLERANCES ARE + 0", - 1/8"



CITY OF ATASCADERO STANDARD DRAWING

DESCRIPTION: HALF ROUND HALF SQUARE TREE GRATE FRAME

APPROVAL: — DATE: XX/XX/2013

RUSSELL S. THOMPSON R.C.E. C43069 EXP. 3/31/14

DRAWN BY: MRW DATE DRAWN: 8/29/06

REVISIONS	BY	APP	DATE
TITLE BLOCK, CURB TYPE	DMA	RST	8/20/10

DRAWING NO.

DI-17

SCALE: N.T.S.

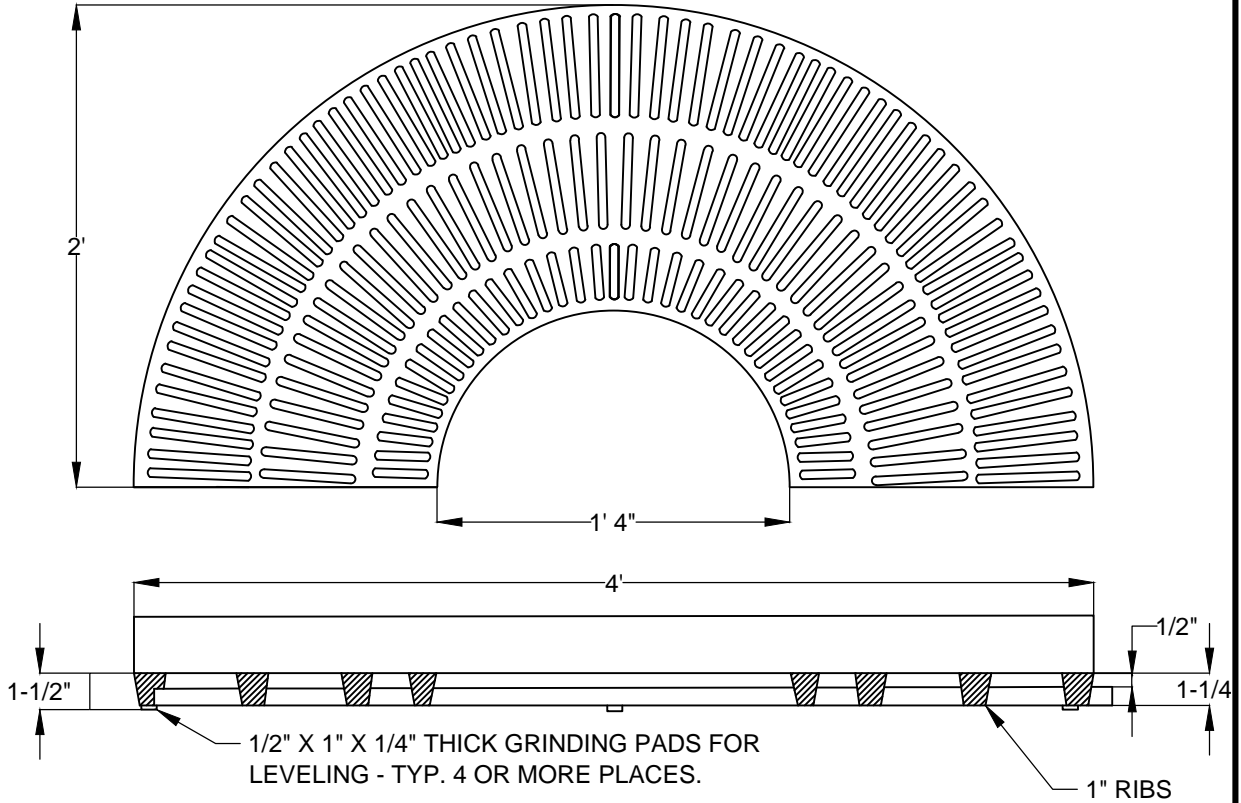

GRATE MODEL NO.	SIZE (INCHES)	TREE OPENING	WEIGHT		USE FRAME
			IRON	ALUMINUM	
M3637	36	12,20	110	40	M3601F
M4837	48	16,24,35	220	79	M4801F
M6059	60	16,24,38	325	117	M6001F
M7265	72	16,24,38	490	176	M7201F

NOTES:

1. SLOT OPENING TAPER FROM 3/8" TO 1/2" MAXIMUM TO MEET A.D.A. GUIDELINES
2. TREE OPENING CAN BE EXPANDED TO ACCOMMODATE GROWTH OR ORDERED WITH LARGER OPENING
3. CAST IRON GRATES ARE DESIGNED TO CARRY PEDESTRIAN LOADS ONLY
4. TREE GRATE SHALL BE FINISHED WITH BLACK ENAMEL



CITY OF ATASCADERO STANDARD DRAWING

DESCRIPTION: **SUNRISE TREE GRATE TOP SECTION**

APPROVAL: — DATE: XX/XX/2013

RUSSELL S. THOMPSON R.C.E. C43069 EXP. 3/31/14

DRAWN BY: MRW DATE DRAWN: 8/29/06

REVISIONS

TITLE BLOCK, CURB TYPE

BY DMA APP RST DATE 8/20/10

DRAWING NO.

DI-18

SCALE: N.T.S.

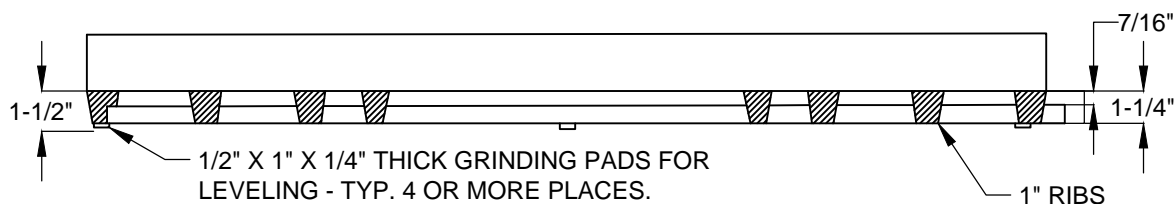
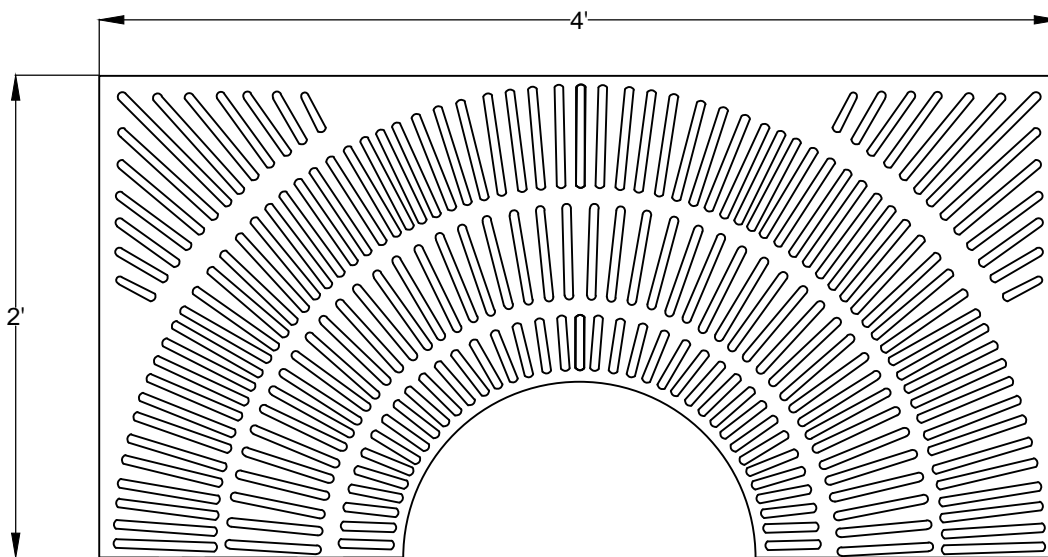

GRATE MODEL NO.	SIZE (INCHES)	TREE OPENING	WEIGHT		USE FRAME
			IRON	ALUMINUM	
M3648	36	12,20	110	49	M3600F
M4848	48	16,24,35	330	103	M4800F
M5674	56	16,24,38	368	132	M5601F
M7264	72	16,24,38	390	140	M6000F
M7264	72	16,24,38	580	209	M7200F

NOTES:

1. SLOT OPENING TAPER FROM 3/8" TO 1/2" MAXIMUM TO MEET A.D.A. GUIDELINES.
2. TREE OPENING CAN BE EXPANDED TO ACCOMMODATE GROWTH OR ORDERED WITH WITH THE LARGER OPENING.
3. CAST IRON GRATES ARE DESIGNED TO CARRY PEDESTRIAN LOADS ONLY
4. ALUMINUM GRATES SHALL ONLY BE USED WITH PERMISSION FROM THE CITY ENGINEER.



CITY OF ATASCADERO STANDARD DRAWING

DESCRIPTION: SUNRISE TREE GRATE BOTTOM SECTION

APPROVAL: — DATE: XX/XX/2013

RUSSELL S. THOMPSON R.C.E. C43069 EXP. 3/31/14

DRAWN BY: MRW DATE DRAWN: 8/29/06

REVISIONS

TITLE BLOCK, CURB TYPE

BY DMA

APP RST

DATE 8/20/10

DRAWING NO.

DI-19

SCALE: N.T.S.

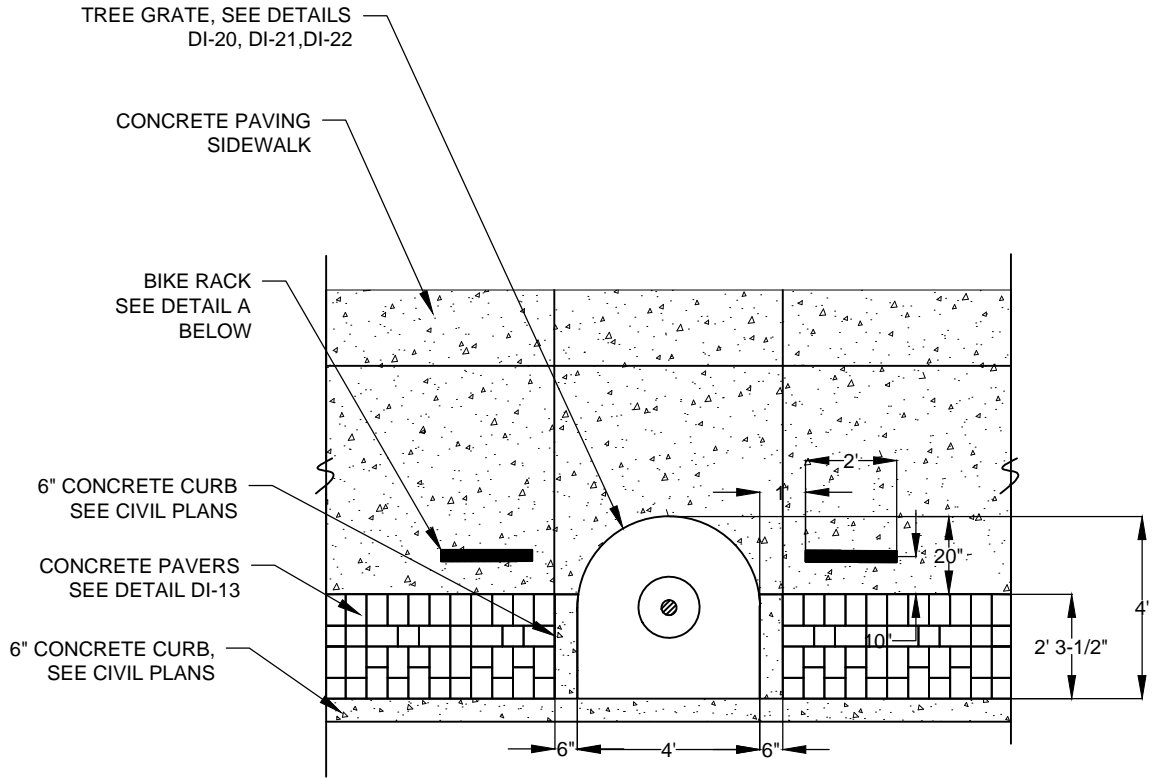

PLAN

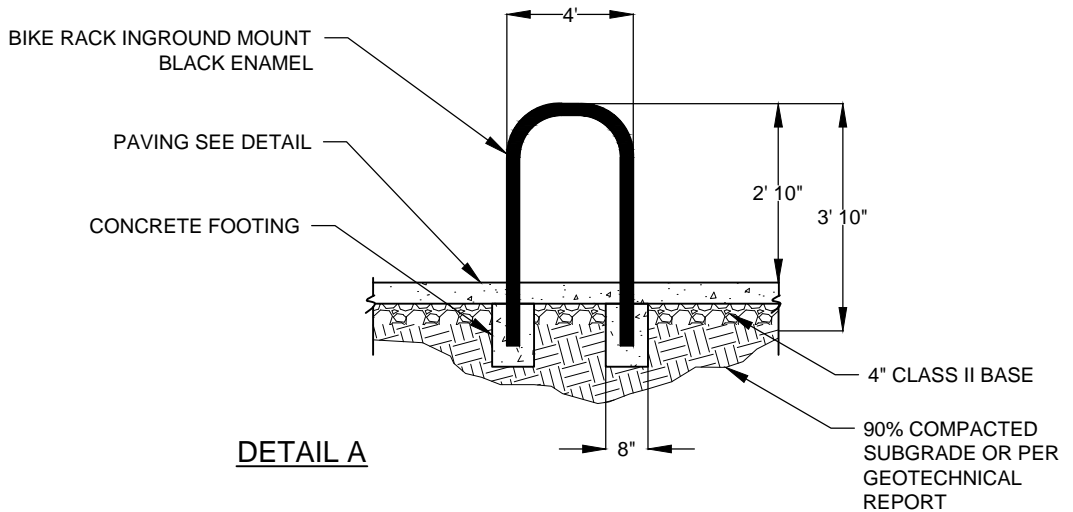

DETAIL A



CITY OF ATASCADERO STANDARD DRAWING

DESCRIPTION: **DOWNTOWN BIKE RACK**

APPROVAL: -- DATE: XX/XX/2013
 RUSSELL S. THOMPSON R.C.E. C43069 EXP. 3/31/14
 DRAWN BY: MRW DATE DRAWN: 8/29/06

REVISIONS	BY	APP	DATE
TITLE BLOCK, CURB TYPE	DMA	RST	8/20/10

DRAWING NO.

DI-20

SCALE: N.T.S.